



EXHAUST HOODS

PREMIER LINE –

LVH, UL Listed Exhaust Hood	2
LVHEB, UL Listed Exhaust Hood for Low Ceilings.	4
LVHRA, UL Listed Exhaust Hood w/ Return Air Plenum.	6
Condensate/Dishwasher Hoods	7

Premier Line UL Exhaust Hoods

LVH - UL Listed Exhaust Hood



Item #: _____ Length: _____
 Model #: **LVH** _____
 Project: _____

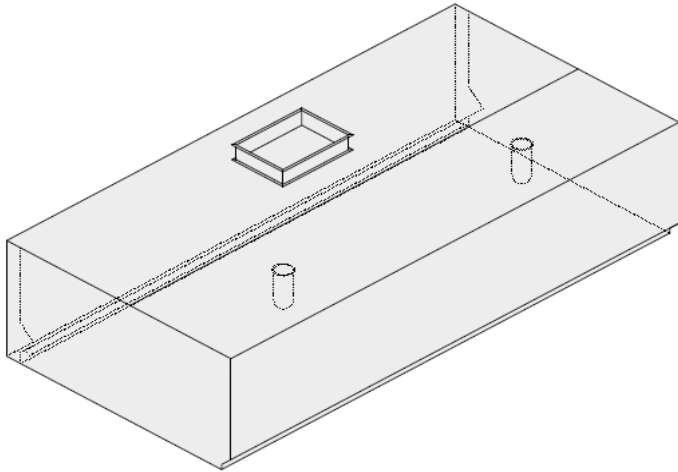

Construction:

- 48" OA front to back and 24" high
- Heavy gauge 430 stainless steel
- Seams are continuously welded liquid tight
- UL listed vapor proof incandescent light fixtures
- UL classified removable aluminum filters
- Grease trough with removable grease cup
- Exhaust collar
- 3" air space rear
- Front and rear hanging brackets

Material:

Hood: 18 gauge stainless steel



Options / Accessories:

- | | |
|--|---|
| <input type="checkbox"/> 3" air space right end | <input type="checkbox"/> 51" OA front to back |
| <input type="checkbox"/> 3" airspace left end | <input type="checkbox"/> Flat, non-insulated wall lining below hood |
| <input type="checkbox"/> 304 stainless steel | <input type="checkbox"/> Flat, insulated wall lining below hood |
| <input type="checkbox"/> Ceiling enclosure panel | <input type="checkbox"/> Flat wall lining w/ 3" air space below hood |
| <input type="checkbox"/> Exhaust duct - see submittal drawings | <input type="checkbox"/> 6" fluted, non-insulated wall lining below hood |
| <input type="checkbox"/> Exhaust blower - see submittal drawings | <input type="checkbox"/> 6" fluted, insulated wall lining below hood |
| <input type="checkbox"/> Make Up Air System - see submittal drawings | <input type="checkbox"/> 6" fluted wall lining w/ 3" air space below hood |
| <input type="checkbox"/> Insulated back | <input type="checkbox"/> Wall lining on left end wall |
| <input type="checkbox"/> Insulated ends | <input type="checkbox"/> Wall lining on right end wall |
| | <input type="checkbox"/> Other _____ |

Submittal drawings required prior to fabrication

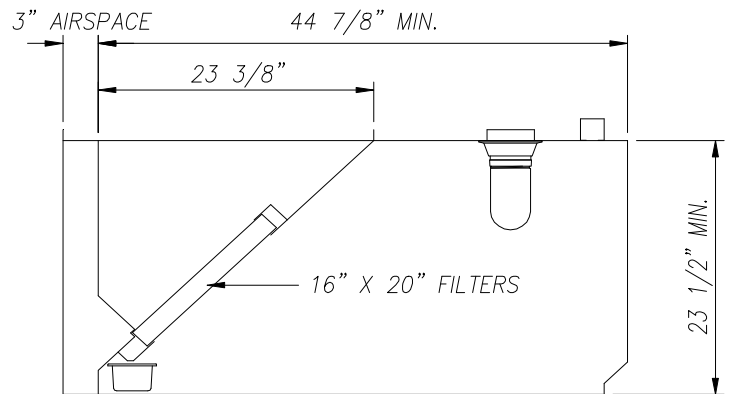
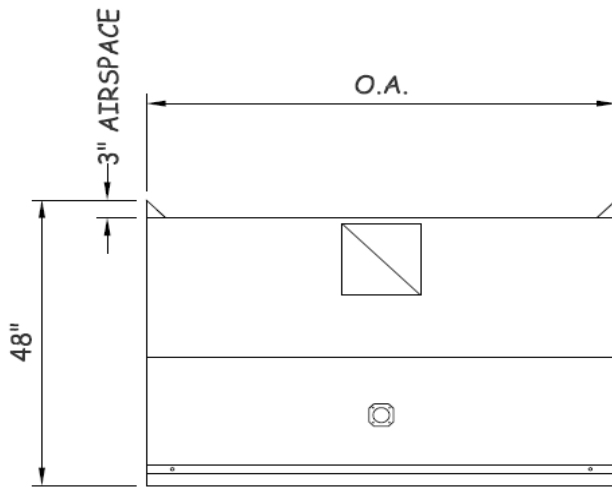

Note: LVH-5 Shown

Series: Low Velocity Hood	Width Min. 48" Length	600 F Max. Cooking Surface				400 F Max. Cooking Surface				No. of Filters	WT
		CFM for 600 F Max	Static Press	Duct Size Sq/In @ 1600 fpm	Duct Size	CFM for 400 F Max	Static Press	Duct Size Sq/In @ 1600 fpm	Duct Size		
LVH 5.0	60	1400	0.5	126	11 1/4 sq.	900	0.39	81	9 sq.	3	350
LVH 5.5	66	1540	0.53	139	11 3/4 sq.	990	0.41	89	9 1/2 sq.	3	385
LVH 6.0	72	1680	0.56	151	12 1/4 sq.	1080	0.43	97	9 3/4 sq.	3	420
LVH 6.5	78	1820	0.63	164	12 3/4 sq.	1170	0.45	105	10 1/4 sq.	3	455
LVH 7.0	84	1960	0.59	176	13 1/4 sq.	1260	0.43	113	10 3/4 sq.	4	525
LVH 7.5	90	2100	0.63	189	13 3/4 sq.	1350	0.44	122	11 sq.	4	562
LVH 8.0	96	2240	0.66	202	14 1/4 sq.	1440	0.45	130	11 1/2 sq.	4	600
LVH 8.5	102	2380	0.63	214	14 3/4 sq.	1530	0.44	138	11 3/4 sq.	5	637
LVH 9.0	108	2520	0.66	227	15 sq.	1620	0.45	146	12 sq.	5	675
LVH 9.5	114	2660	0.71	239	15 1/2 sq.	1710	0.46	154	12 1/2 sq.	5	712
LVH 10.0	120	2800	0.71	252	15 3/4 sq.	1800	0.44	162	12 3/4 sq.	6	750
LVH 10.5	126	2940	0.73	264	16x16 1/2	1890	0.45	170	13 sq.	6	787
LVH 11.0	132	3080	0.74	280	16x17 1/2	1980	0.46	178	13 1/4 sq.	6	825
LVH 11.5	138	3220	0.76	289	16x18	2070	0.47	186	13 3/4 sq.	6	862
LVH 12.0	144	3360	0.76	302	16x19	2160	0.46	194	14 sq.	7	900
LVH 12.5	150	3500	0.78	312	16x19 1/2	2250	0.48	203	14 1/4 sq.	7	937
LVH 13.0	156	3640	0.8	320	16x20	2340	0.5	211	14 1/2 sq.	7	975
LVH 13.5	162	3780	0.82	336	16x21	2430	0.5	219	14 3/4 sq.	8	1012
LVH 14.0	168	3920	0.85	352	16x22	2520	0.52	227	15 sq.	8	1050
LVH 14.5	174	4060	0.88	368	16x23	2610	0.54	235	15 1/4 sq.	8	1087
LVH 15.0	180	4200	0.89	276	16x23 1/2	2700	0.54	243	15 1/2 sq.	9	1125
LVH 15.5	186	4340	0.92	392	16x24 1/2	2790	0.56	251	15 3/4 sq.	9	1162
LVH 16.0	192	4480	0.95	400	16x25	2880	0.58	259	16 sq.	9	1200

www.weststarindustries.com

4445 E. Fremont Street / Stockton, CA 95215

Phone: 800-326-2288 Fax: (209) 955-8250 CL# 422322

Email: ws@weststarindustries.com

Note: Specifications are subject to change without notice.

Premier Line UL Exhaust Hoods

LVHEB - UL Listed Exhaust Hood



Item #: _____ Length: _____
 Model #: **LVHEB**
 Project: _____

FOR LOW CEILING HEIGHTS

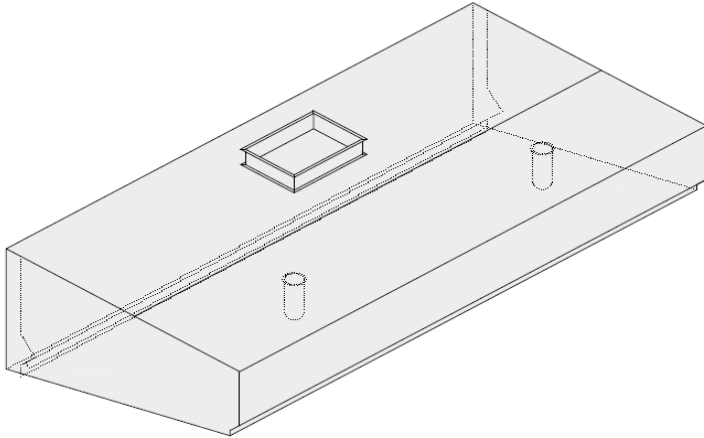

Construction:

- 48" OA front to back
- 24"H rear, minimum 15"H front
- Heavy gauge 430 stainless steel
- Seams are continuously welded liquid tight
- UL listed vapor proof incandescent light fixtures
- UL classified removable aluminum filters
- Grease trough with removable grease cup
- Exhaust collar
- 3" air space rear
- Front and rear hanging brackets

Material:

Hood: 18 gauge stainless steel



Options / Accessories:

- | | |
|--|---|
| <input type="checkbox"/> 3" air space right end | <input type="checkbox"/> 51" OA front to back |
| <input type="checkbox"/> 3" airspace left end | <input type="checkbox"/> Flat, non-insulated wall lining below hood |
| <input type="checkbox"/> 304 stainless steel | <input type="checkbox"/> Flat, insulated wall lining below hood |
| <input type="checkbox"/> Ceiling enclosure panel | <input type="checkbox"/> Flat wall lining w/ 3" air space below hood |
| <input type="checkbox"/> Exhaust duct - see submittal drawings | <input type="checkbox"/> 6" fluted, non-insulated wall lining below hood |
| <input type="checkbox"/> Exhaust blower - see submittal drawings | <input type="checkbox"/> 6" fluted, insulated wall lining below hood |
| <input type="checkbox"/> Make Up Air System - see submittal drawings | <input type="checkbox"/> 6" fluted wall lining w/ 3" air space below hood |
| <input type="checkbox"/> Insulated back | <input type="checkbox"/> Wall lining on left end wall |
| <input type="checkbox"/> Insulated ends | <input type="checkbox"/> Wall lining on right end wall |
| | <input type="checkbox"/> Other _____ |

Submittal drawings required prior to fabrication

www.weststarindustries.com
 4445 E. Fremont Street / Stockton, CA 95215
 Phone: 800-326-2288 Fax: (209) 955-8250 CL# 422322
 Email: wsi@weststarindustries.com

Note: Specifications are subject to change without notice.

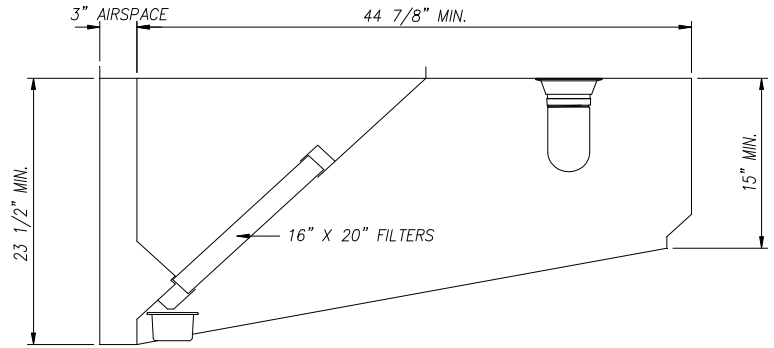
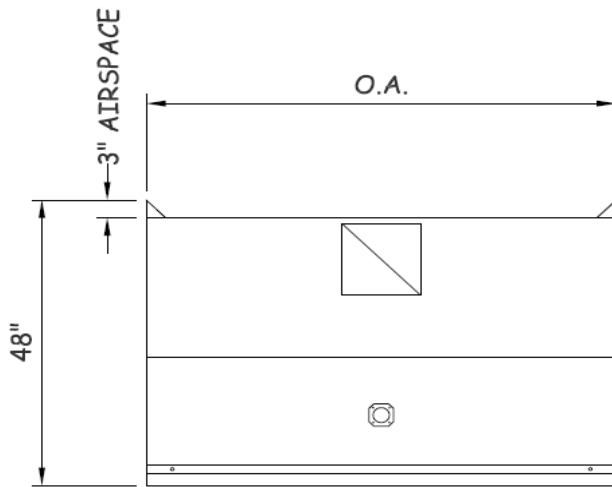

Note: LVHEB-5 Shown

Series: Low Velocity Hood	Width Min. 48" Length	600 F Max. Cooking Surface				400 F Max. Cooking Surface				No. of Filters	WT
		CFM for 600 F Max	Static Press	Duct Size Sq/In @ 1600 fpm	Duct Size	CFM for 400 F Max	Static Press	Duct Size Sq/In @ 1600 fpm	Duct Size		
LVHEB 5.0	60	1540	0.5	126	11 1/4 sq.	990	0.39	81	9 sq.	3	350
LVHEB 5.5	66	1694	0.53	139	11 3/4 sq.	1089	0.41	89	9 1/2 sq.	3	385
LVHEB 6.0	72	1848	0.56	151	12 1/4 sq.	1188	0.43	97	9 3/4 sq.	3	420
LVHEB 6.5	78	2002	0.63	164	12 3/4 sq.	1287	0.45	105	10 1/4 sq.	3	455
LVHEB 7.0	84	2156	0.59	176	13 1/4 sq.	1386	0.43	113	10 3/4 sq.	4	525
LVHEB 7.5	90	2310	0.63	189	13 3/4 sq.	1485	0.44	122	11 sq.	4	562
LVHEB 8.0	96	2464	0.66	202	14 1/4 sq.	1584	0.45	130	11 1/2 sq.	4	600
LVHEB 8.5	102	2618	0.63	214	14 3/4 sq.	1683	0.44	138	11 3/4 sq.	5	637
LVHEB 9.0	108	2772	0.66	227	15 sq.	1782	0.45	146	12 sq.	5	675
LVHEB 9.5	114	2962	0.71	239	15 1/2 sq.	1881	0.46	154	12 1/2 sq.	5	712
LVHEB 10.0	120	3080	0.71	252	15 3/4 sq.	1980	0.44	162	12 3/4 sq.	6	750
LVHEB 10.5	126	3234	0.73	264	16x16 1/2	2079	0.45	170	13 sq.	6	787
LVHEB 11.0	132	3388	0.74	280	16x17 1/2	2178	0.46	178	13 1/4 sq.	6	825
LVHEB 11.5	138	3542	0.76	289	16x18	2277	0.47	186	13 3/4 sq.	6	862
LVHEB 12.0	144	3696	0.76	302	16x19	2376	0.46	194	14 sq.	7	900
LVHEB 12.5	150	3850	0.78	312	16x19 1/2	2475	0.48	203	14 1/4 sq.	7	937
LVHEB 13.0	156	4004	0.8	320	16x20	2574	0.5	211	14 1/2 sq.	7	975
LVHEB 13.5	162	4158	0.82	336	16x21	2673	0.5	219	14 3/4 sq.	8	1012
LVHEB 14.0	168	4312	0.85	352	16x22	2772	0.52	227	15 sq.	8	1050
LVHEB 14.5	174	4466	0.88	368	16x23	2871	0.54	235	15 1/4 sq.	8	1087
LVHEB 15.0	180	4620	0.89	276	16x23 1/2	2970	0.54	243	15 1/2 sq.	9	1125
LVHEB 15.5	186	4774	0.92	392	16x24 1/2	3069	0.56	251	15 3/4 sq.	9	1162
LVHEB 16.0	192	4928	0.95	400	16x25	3168	0.58	259	16 sq.	9	1200

www.weststarindustries.com

4445 E. Fremont Street / Stockton, CA 95215

Phone: 800-326-2288 Fax: (209) 955-8250 CL# 422322

Email: ws@weststarindustries.com

Note: Specifications are subject to change without notice.

Premier Line UL Exhaust Hoods

LVHRA - Return Air UL Listed Exhaust Hood



Item #: _____ Length: _____
 Model #: **LVHRA**
 Project: _____

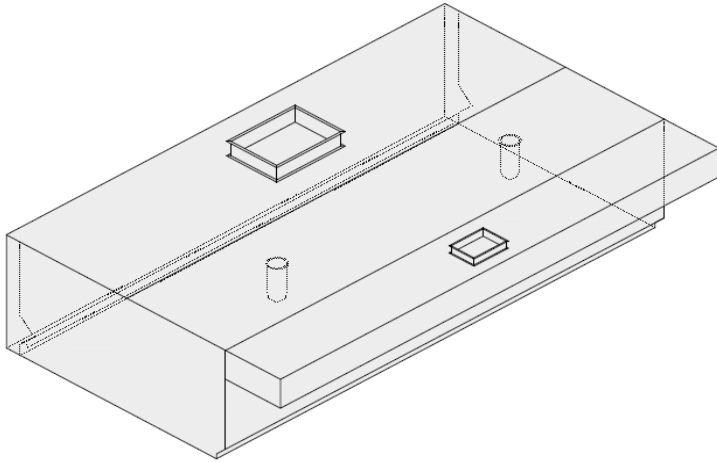

Construction:

- 48" OA front to back and 24" high
- Return air plenum attached to front of exhaust hood
- Heavy gauge 430 stainless steel
- Seams are continuously welded liquid tight
- UL listed vapor proof incandescent light fixtures
- UL classified removable aluminum filters
- Grease trough with removable grease cup
- Exhaust collar
- 3" air space rear
- Front and rear hanging brackets

Material:

Hood: 18 gauge stainless steel



Options / Accessories:

- | | |
|--|---|
| <input type="checkbox"/> 3" air space right end | <input type="checkbox"/> 51" OA front to back |
| <input type="checkbox"/> 3" airspace left end | <input type="checkbox"/> Flat, non-insulated wall lining below hood |
| <input type="checkbox"/> 304 stainless steel | <input type="checkbox"/> Flat, insulated wall lining below hood |
| <input type="checkbox"/> Ceiling enclosure panel | <input type="checkbox"/> Flat wall lining w/ 3" air space below hood |
| <input type="checkbox"/> Exhaust duct - see submittal drawings | <input type="checkbox"/> 6" fluted, non-insulated wall lining below hood |
| <input type="checkbox"/> Exhaust blower - see submittal drawings | <input type="checkbox"/> 6" fluted, insulated wall lining below hood |
| <input type="checkbox"/> Make Up Air System - see submittal drawings | <input type="checkbox"/> 6" fluted wall lining w/ 3" air space below hood |
| <input type="checkbox"/> Insulated back | <input type="checkbox"/> Wall lining on left end wall |
| <input type="checkbox"/> Insulated ends | <input type="checkbox"/> Wall lining on right end wall |
| | <input type="checkbox"/> Other _____ |

Submittal drawings required prior to fabrication

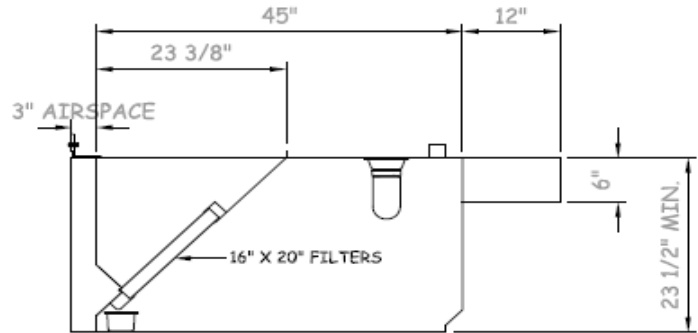
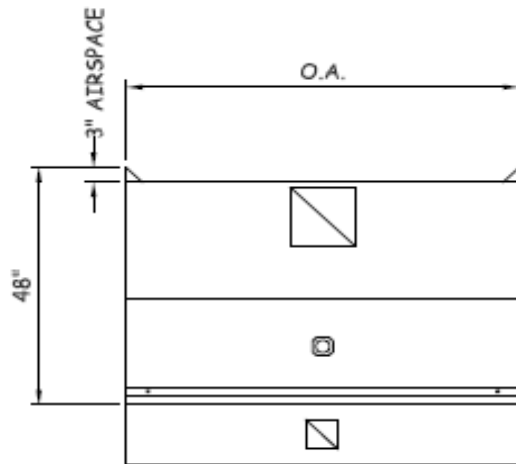

Note: LVHRA-5 Shown

Series: Low Velocity Hood	Width Min. 48" Length	600 F Max. Cooking Surface				400 F Max. Cooking Surface				No. of Filters	WT
		CFM for 600 F Max	Static Press	Duct Size Sq/ln @ 1600 fpm	Duct Size	CFM for 400 F Max	Static Press	Duct Size Sq/ln @ 1600 fpm	Duct Size		
LVHRA 5.0	60	1400	0.5	126	11 1/4 sq.	900	0.39	81	9 sq.	3	450
LVHRA 5.5	66	1540	0.53	139	11 3/4 sq.	990	0.41	89	9 1/2 sq.	3	495
LVHRA 6.0	72	1680	0.56	151	12 1/4 sq.	1080	0.43	97	9 3/4 sq.	3	540
LVHRA 6.5	78	1820	0.63	164	12 3/4 sq.	1170	0.45	105	10 1/4 sq.	3	585
LVHRA 7.0	84	1960	0.59	176	13 1/4 sq.	1260	0.43	113	10 3/4 sq.	4	665
LVHRA 7.5	90	2100	0.63	189	13 3/4 sq.	1350	0.44	122	11 sq.	4	712
LVHRA 8.0	96	2240	0.66	202	14 1/4 sq.	1440	0.45	130	11 1/2 sq.	4	760
LVHRA 8.5	102	2380	0.63	214	14 3/4 sq.	1530	0.44	138	11 3/4 sq.	5	807
LVHRA 9.0	108	2520	0.66	227	15 sq.	1620	0.45	146	12 sq.	5	855
LVHRA 9.5	114	2660	0.71	239	15 1/2 sq.	1710	0.46	154	12 1/2 sq.	5	912
LVHRA 10.0	120	2800	0.71	252	15 3/4 sq.	1800	0.44	162	12 3/4 sq.	6	950
LVHRA 10.5	126	2940	0.73	264	16x16 1/2	1890	0.45	170	13 sq.	6	997
LVHRA 11.0	132	3080	0.74	280	16x17 1/2	1980	0.46	178	13 1/4 sq.	6	1045
LVHRA 11.5	138	3220	0.76	289	16x18	2070	0.47	186	13 3/4 sq.	6	1092
LVHRA 12.0	144	3360	0.76	302	16x19	2160	0.46	194	14 sq.	7	1140
LVHRA 12.5	150	3500	0.78	312	16x19 1/2	2250	0.48	203	14 1/4 sq.	7	1187
LVHRA 13.0	156	3640	0.8	320	16x20	2340	0.5	211	14 1/2 sq.	7	1235
LVHRA 13.5	162	3780	0.82	336	16x21	2430	0.5	219	14 3/4 sq.	8	1282
LVHRA 14.0	168	3920	0.85	352	16x22	2520	0.52	227	15 sq.	8	1330
LVHRA 14.5	174	4060	0.88	368	16x23	2610	0.54	235	15 1/4 sq.	8	1377
LVHRA 15.0	180	4200	0.89	376	16x23 1/2	2700	0.54	243	15 1/2 sq.	9	1425
LVHRA 15.5	186	4340	0.92	392	16x24 1/2	2790	0.56	251	15 3/4 sq.	9	1472
LVHRA 16.0	192	4480	0.95	400	16x25	2880	0.58	259	16 sq.	9	1520

www.weststarindustries.com

4445 E. Fremont Street / Stockton, CA 95215

Phone: 800-326-2288 Fax: (209) 955-8250 CL# 422322

Email: wsj@weststarindustries.com

Note: Specifications are subject to change without notice.



Item #: _____ Qty #: _____
 Model #: _____
 Project: _____

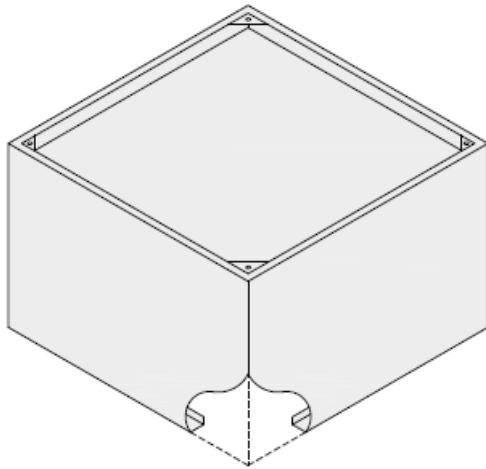

Construction:

- 304 stainless steel
- Heavy duty construction
- 2" perimeter gutter
- Front and rear mounting brackets



Material:

Hood: 18 ga. Type 304 Stainless Steel

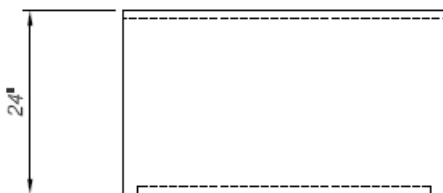
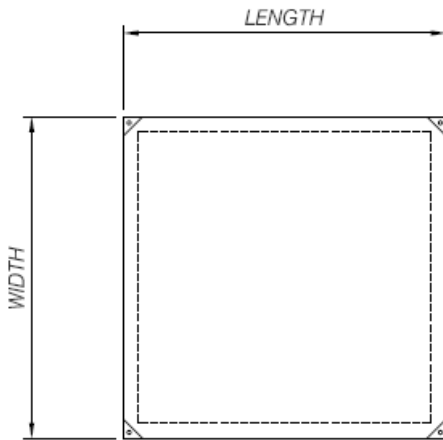

Options:

- Exhaust collar (Hi-Temp DW) - see submittal drawings
- Exhaust blower - see submittal drawings
- Exhaust duct - see submittal drawings
- Ceiling enclosure panel
- Other _____

MODEL NUMBER	LENGTH (A)	WIDTH (B)	DEPTH (C)	WT. (LBS.)
DW 3636	36"	36"	24"	120
DW 4242	42"	42"	24"	150
DW 6036	60"	36"	24"	180